

# Usage instructions Solarlight "Swing"

GB

These instructions relate **ONLY** to this product and contain important information for using the product for the first time. Please keep these instructions for later reference and should always accompany the product in the event of transference to a new user.

## 1. Introduction

Dear Customer,

Thank you for purchasing the solar light.

With this solar light you purchased a product manufactured according to the current state of technology.

**This product fulfils all requirements of the valid European and national regulations. The conformity was proved. The relevant declarations and documentation are deposited with the manufacturer.**

To maintain this state and guarantee a safe operation, you as the user will have to follow this operating manual!

## 2. Safety Instructions



- In case of damages caused by not following this operating manual, the warranty rights will expire! We exclude liability for any consequential damages!
- We exclude liability for property or personal damages caused by inappropriate handling or not following the safety instructions.
- In these cases any guarantee rights will expire.

Due to safety and admission reasons (CE) it is not allowed to arbitrarily reconstruct and/or change the solar light.

Therefore, please keep to the operating manual.

The accident prevention rules of the association of the industrial trade cooperative association for electric plants and working material are to be considered in industrial environments

## 3. Usage in Accordance with Requirements

The solar light is constructed for the outdoor usage and operation. The integrated accumulators are charged by the solar cell in the upper part of the light. At darkness, the light is automatically switched on and is switched out at sunrise. As light source, 1 very strong light emitting diode (LED) are installed. These LED guarantee a strong luminosity with only low power consumption.

-- However, please note that the duration of illumination may decrease due to a lack of sunshine as well as in the winter months--

In case of longer periods without sunshine (insolation) the accumulator is charged only insufficiently and is thus not able to guarantee a permanent readiness for operation. However, this does not indicate that the solar light is defect. Please wait for the next sunny days and the light will again be working accordingly

## 4. Initiation

1. Please carefully take all parts out of the package.
2. Please carefully connect the earth rod with the bar and insert it into the ground.

**Note:** Please do not use force.

3. Adjust the switch below the lamp shade to the position "ON" and carefully insert the upper part of the lamp onto the receiver module on the bar.

**The solar light is now activated.**

**Note:** The duration of illumination is strongly dependent on the intensity and duration of sunshine during the day. During the winter months the duration of illumination will generally be shorter. If the lamp should not irradiate on the first evening, please wait for a sunny day.

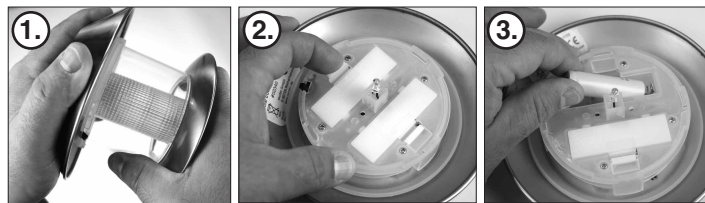
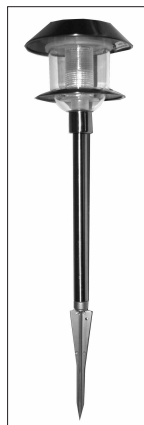
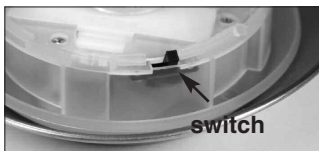

## 5. Exchange of Accumulators

1. Hold the upper part and screw off the lower part of the lamp head and take apart the parts.
2. Unscrew the reflector also and remove it.
3. Open the two battery compartments by pressing the lock.
4. Take the used accumulators out of the battery compartment and insert two new accumulators, according to polarity, into the battery compartment. It is recommended to charge the new accumulators in a battery charger before inserting them.
5. Re-assemble the lamp in reverse order.

**Note:** Used batteries or accumulators must be disposed of in a non-polluting way and do not belong into the domestic waste. Your dealer is legally obliged to take back and recycle old accumulators.

## 6. Malfunctions

-Lamp is not automatically switched on at darkness

- An outside light source (e.g. streetlight) simulates daylight and prevents the lamp from switching on. Place the lamp at a darker location.

- Lamp is not switched on at darkness or only for a short period of time.

- Is the lamp connected?

- Accumulator weak or defective. Exchange of the accumulators.

## 7. Technical Data

Operation voltage:	2.4 V
Set of accumulators:	2 x NiMh 1.2 V/600 mAh
Light emitting diode:	1 white light emitting diode (LED)
Solar module:	crystal silicon
Duration of illumination:	max. 12 hours in case of fully charged set of accumulators

## Battery Recycling:

- Used batteries or accumulators must be disposed in the domestic waste.
- The consumer is legally obliged to bring back old accumulators upon usage, e.g. to public waste collecting locations or to the place (shops, etc.) where those batteries are sold.
- Batteries that contain harmful substances are marked with the "strike through dustbin" and one of the chemical symbols Cd (= battery contains cadmium), Hg (= battery contains hydrargyrum), Pb (= battery contains lead).

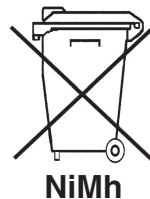

NiMh

## Manufacturer/Importer:

esotec GmbH, Etzenrichterstr. 14, D-92729 Weiherhammer

Tel.-Nr: 09605-92206-28, Fax.-Nr: 09605-92206-10,

e-mail:info@esotec.de, www.sunnytrend.de

**Mnufacturer Part- Nr: 102070**

## Disposal:

Dear customer,

please cooperate in avoiding waste. When you intend to dispose of the product in future, please consider that it contains valuable raw materials suited for recycling.

Therefore, do not dispose it of with domestic waste but bring it to a collection point for the recycling of waste electrical and electronic equipment.

Thank you very much for your cooperation!

Copyright, esotec GmbH