

Datasheet

Item no. 1577328

Super Flux LED

3 mm

- Anschluss THR
- Ausführung Super Flux
- Linse wasserklar

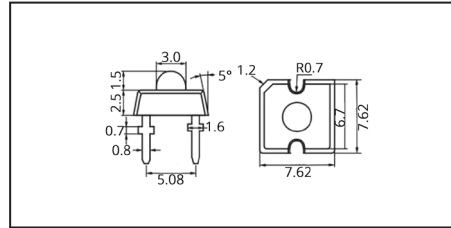

| Artkbez: | Farbe: | Wellenlänge: | Helligkeit: | Farbtemperatur: | Winkel: | Betriebsspannung: |
|----------|--------|--------------|-----------------|-----------------|---------|-------------------|
| 1577305 | ●rot | 620 - 635 nm | 1000 - 1500 mcd | | 100 ° | 1,9 V - 2,3 V |
| 1577435 | ●gelb | 580 - 595 nm | 1000 - 1500 mcd | | 100 ° | 1,9 V - 2,3 V |
| 1577317 | ●grün | 520 - 530 nm | 2000 - 3000 mcd | | 100 ° | 2,9 V - 3,5 V |
| 1577328 | ●blau | 460 - 470 nm | 1000 - 1500 mcd | | 100 ° | 2,9 V - 3,5 V |
| 1577436 | ○weiß | | 2000 - 2500 mcd | 5500 - 6500 K | 100 ° | 2,9 V - 3,5 V |

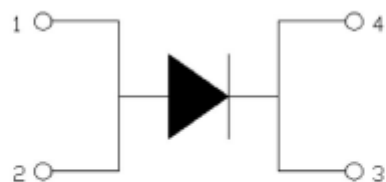
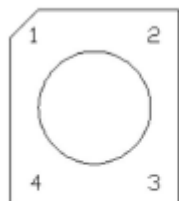

Blue/Green/White

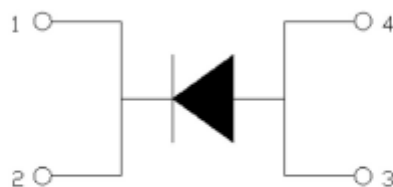
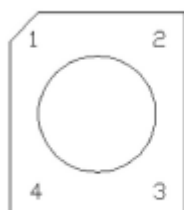

Red/Yellow

